

LD60



IP68  

General Information

A versatile tough miniature LED fitting similar to an LD41, but the slightly larger bezel can be more forgiving if a cut-out hole isn't perfect.

Useful for accent uplighting, downlighting, highlighting niches etc.

The fitting is either directly bonded with the surface or held in place by 'O' Rings and a /480 installation sleeve. Made from a solid billet of stainless steel 316.

Integral anti-wicking barrier increases protection against moisture ingress due to incorrect IP rated cable connections.

Output Options

1.2W LED at 350mA

1.7W LED at 500mA

Lamp Options: 350mA 1w

Warm White (3000k)

Cool White (5000k)

Blue

Green

Red

Amber

Lens Options

12° narrow spot

31° medium

48° wide

36° x 12° oval

Bezel finish options

Stainless steel 316 (standard)

Driver Options.

Use with 350mA and 500mA constant current LED drivers 1-10V, DMX, DALI and Mains dimmable, or non dim.



Notes

Do not wire LEDs 'live' - power supply must be turned off and driver discharged. Wire in series and observe correct polarity.

Fixing Options

/480 - 'O' rings and sleeve

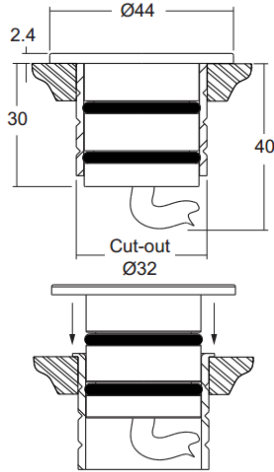

Fixing Options

/SC - Spring clips

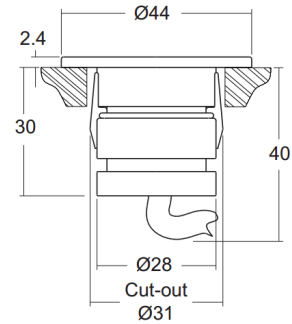

Applications

Recessed uplighting, External, Steps, Pathway

Beam Angles

12°, 31°, 48°, 36° x 12°

LED type

1 x Cree XPG

Colour temperature

3000K

5000K

	3000K		5000K	
Drive Current (mA)	350	500	350	500
LED power* (W)	1.2W	1.7W	1.2W	1.7W
CRI (typical)	93	93	80	80
Forward voltage (V)	3.0V	3.2V	3.0V	3.2V
Delivered lumens (L ¹⁰⁰)	68	93	110	153
Lumens per circuit watt**	57	55	91	90

LED lifetime (to 70% lumen maintenance)

50,000hrs at a max ambient temperature of 35°C (if specifying fitting in ambient temperatures of up to 45°C run at 350mA max, LD60-350)