

# LD82/PL1

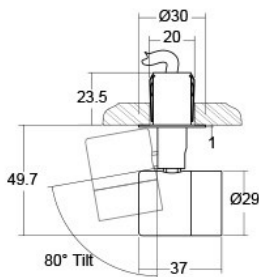

**IP40**  

## Notes

Wire in series and observe correct polarity  
Do not wire 'live'

## General Information

Punchy surface mounted miniature LED spotlight  
The LD82 is a high power, miniature LED spotlight with a drive current of up to 700mA (2.4W). It utilizes the latest LED technology with a typical CRI of 93 in warm white, making it ideal for showcase and display in retail environments where high CRI is required. The spotlight is mounted on a matching knuckle joint allowing easy adjustment and focusing. .

It's performance is the same as the LD51. The differences are the fixing method, the knuckle detail, cowl detail and the IP rating.

## /PL-1

PL-1: is a very discreet method of mounting a single spotlight into the base or side of a cabinet or showcase

## Output Options:

- 1.2W LED at 350mA
- 1.7W LED at 500mA
- 2.4W LED at 700mA

## Lamp Options:

- 2700K
- 3000K
- 5000K
- Blue
- Green
- Red
- Amber

## Lens Options:

- 12° narrow spot
- 31° medium
- 48° wide
- 36° x 12° oval beam

## Finishes:

- Silver or Black Anodised
- Powder coated Matt Black or Matt White (RAL 9016)

## Accessories:

- CO - Optional Anti-glare cowl

## Driver Options:

Use with 350mA, 500mA or 700mA constant current LED Drivers. 1-10V, DMX, DALI and Mains dimmable, or non-dim